

RIKON POWER TOOLS

Mini Lathe Model: 70-100



Record the serial number and date of purchase
in your manual for future reference.

Serial number: _____

Date of purchase: _____

For more information:
www.rikontools.com or info@rikontools.com
For Parts or Questions:
techsupport@rikontools.com or 877-884-5167

Explosion Diagram

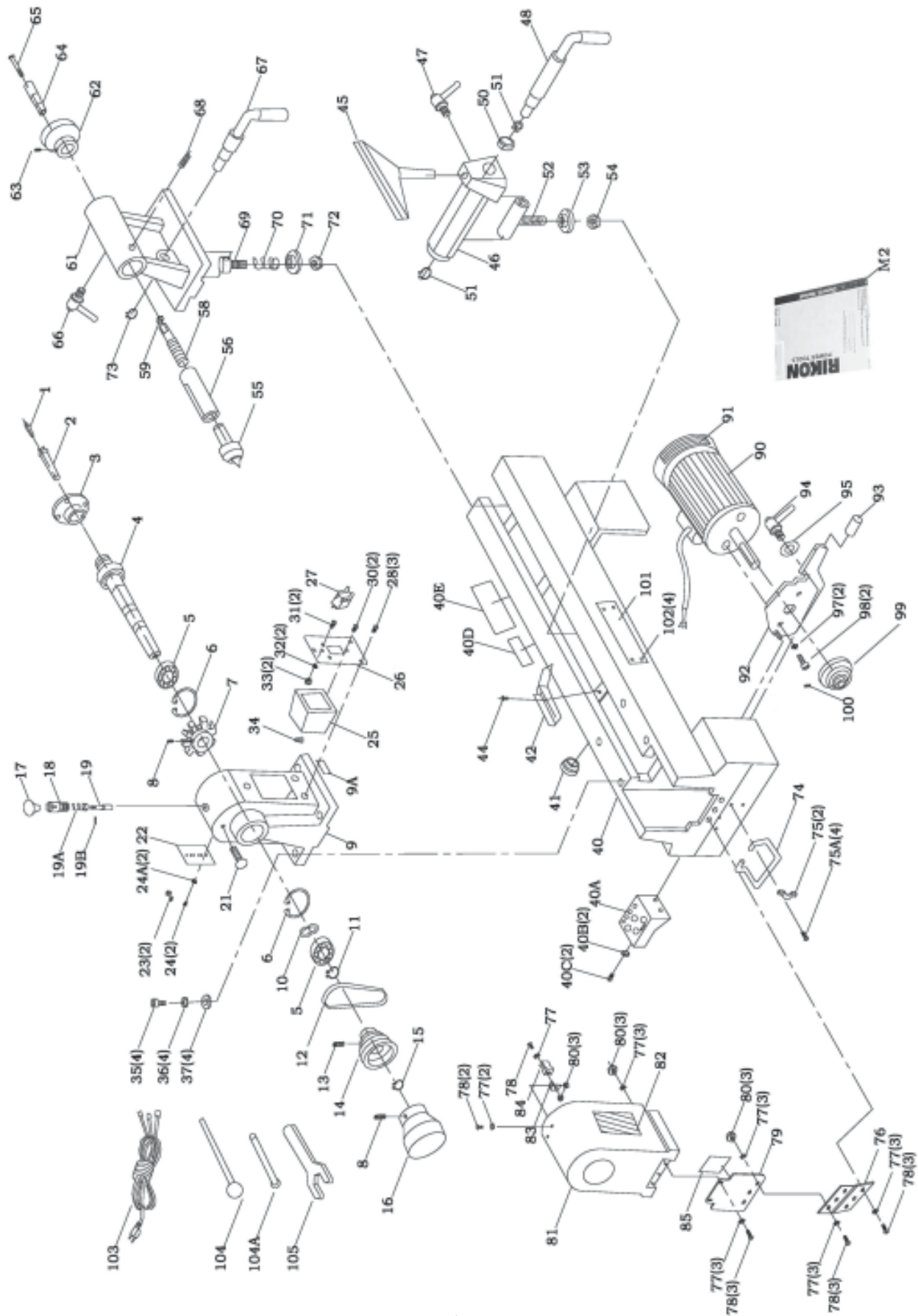

Parts List

KEY No.	Description	Part No.	KEY No.	Description	Part No.
70-100 1	Center point	1-JL93010001	70-100 51	Ring retaining 12mm	1-CLP12GB894D1B
70-100 2	Spur center	1-JL93010002	70-100 52	Clamp bolt cover	1-JL93020005
70-100 3	Faceplate	1-JL93010003-001Y	70-100 53	Position plate	1-JL93030012
70-100 4	Spindle shaft	1-JL93010004	70-100 54	Lock nut M10	1-M10GB889Z
70-100 5	Bearing 6005-2Z	1-BRG6005-2RSV2	70-100 55	Live center	1-JL93031000
70-100 6	Ring retaining 47mm	1-CLP47GB893D1B	70-100 56	Axle sleeve	1-JL93030001
70-100 7	Indexing gear	1-JL93010006	70-100 58	Bolt	1-JL93030003
70-100 8	Hex socket set screw M6x8	1-M6X8GB80B	70-100 59	Ring retaining	1-CLP12GB896B
70-100 9	Spindle head	1-JL93010007-050W	70-100 61	Tail stock	1-JL93030005-050W
70-100 9A	Warning label	1-RK93081006	70-100 62	Handwheel	1-JL90030006
70-100 10	Wave washer 47mm	1-JL93010008	70-100 63	Hex. Socket set screw M6x12	1-M6X12GB80B
70-100 11	Ring retaining 25mm	1-CLP25GB894D1B	70-100 64	Handwheel handle	1-JL93030007
70-100 12	Poly-v-belt	1-JL93010009	70-100 65	Screw	1-JL93030009
70-100 13	Hex socket set screw M6x12	1-M6X12GB80B	70-100 66	Lock arm	1-JL93021000
70-100 14	Spindle pulley	1-JL93010010	70-100 67	Lock lever	1-JL93030009
70-100 15	Ring retaining 19mm	1-CLP19GB894D1B	70-100 68	Hex. Socket set screw M5x8	1-M5X8GB77B
70-100 16	Handwheel	1-JL93010011	70-100 69	Scr shaft	1-JL93030010
70-100 17	Spindle lock knob	1-0804011-01001S	70-100 70	Spring	1-JL93030011
70-100 18	Spindle lock tube	1-JL93010013	70-100 71	Clamp plate	1-JL93030012
70-100 19	Spindle lock shaft	1-JL93010015	70-100 72	Lock nut M10	1-M10GB889Z
70-100 19A	Spindle lock spring	1-JL93010014	70-100 73	Ring retaining 10mm	1-CLP10GB894D1B
70-100 19B	Pin roll 3x16	1-PIN3X16GB879D1B	70-100 74	Lifting handle	1-JL93050001
70-100 21	Rounded insert	1-JL93010016	70-100 75	Lifting handle clamping	1-JL93050002
70-100 22	Power cable plate	1-JL93040001	70-100 75A	Pan head screw M5x10	1-M5X10GB818B
70-100 23	Strain relief	1-403106	70-100 76	Hinge	1-JL93050003
70-100 24	Pan head screw M5x12	1-M5X12GB818B	70-100 77	Lock washer M4	1-WSH4GB862D1B
70-100 24A	Locking washer M5	1-WSH5GB862D2B	70-100 78	Pan head screw M4x10	1-M4X10GB818B
70-100 25	Box switch	1-JL93040002-001S	70-100 79	Motor pulley cover	1-JL93050004-001Z
70-100 26	Switch plate	1-JL93040003	70-100 80	Hex. Nut M4	1-M4GB6170B
70-100 27	Lock switch	1-J-9301B	70-100 81	Access cover	1-JL93050005-001S
70-100 28	Pan head screw M6x10	1-M6X10GB818B	70-100 82	Warning label	1-RK93081004
70-100 30	Pan head tapping screw ST4.2x22	1-ST4D2X25GB845B	70-100 83	Lock housing bracket	1-JL93050006
70-100 31	Pan head screw M4x10	1-M4X10GB818B	70-100 84	Lock housing	1-JL93050007
70-100 32	Locking washer M4	1-WSH4GB862D1B	70-100 85	Belt position chart	1-RK93081003
70-100 33	Hex. Nut M4	1-M4GB6170Z	70-100 90	Motor	1-H3612624
70-100 34	Close-end connector	1-JL93040008	70-100 91	Motor label	1-RK93081009
70-100 35	Hex. Socket head screw M6x35	1-M6X35GB70B	70-100 92	Belt tension handle	1-JL93041000
70-100 36	Spring washer 6mm	1-WSH6GB93B	70-100 93	Belt tension handle cover	1-JL93040005
70-100 37	Washer 6mm	1-WSH6GB97D1Z	70-100 94	Locking arm	1-JL93021000B
70-100 40	Bed	1-JL93010021-049W	70-100 95	Special washer 8mm	1-JL93040007
70-100 40A	Tool holder	1-JL93010017-001S	70-100 97	Spring washer 6mm	1-WSH6GB93B
70-100 40B	Washer 6mm	1-WSH6 GB97D1B	70-100 98	Hex. Socket head screw M6x15	1-M6X15GB70B
70-100 40C	Pan head screw M6x16	1-M6X16GB818B	70-100 99	Motor pulley	1-JL93040006
70-100 40D	Name label	1-RK93081002	70-100 100	Hex. Socket set screw M6x12	1-M6X12GB78B
70-100 40E	Warning label	1-RK93081005	70-100 101	Brand label	1-RK93081001
70-100 41	Cable tube	1-JL93040004-001S	70-100 102	Rivet M2.5x5	1-RVT2D5X5GB827C
70-100 42	Fence	1-JL93010019-001Z	70-100 103	Power cable	1-U23182300-472
70-100 44	Pan head screw M5x10	1-M5X10GB818B	70-100 104	Knokout bar	1-JL93070002
70-100 45	8" tool holder	1-JL93020001-001G	70-100 104A	Knokout bar	1-JL93070001
70-100 46	Tool holder seat	1-JL93020002-105L	70-100 105	Wrench	1-JL93070003
70-100 47	Lock arm	1-JL930210000A	70-100 M2	Manual	1-RK93082006
70-100 48	Lock lever	1-JL93020003			
70-100 50	Collar	1-JL93020004			



5-Year Limited Warranty

RIKON Power Tools, Inc. ("Seller") warrants to only the original retail consumer/purchaser of our products that each product be free from defects in materials and workmanship for a period of five (5) years from the date the product was purchased at retail. This warranty may not be transferred.

This warranty does not apply to defects due directly or indirectly to misuse, abuse, negligence, accidents, repairs, alterations, lack of maintenance or normal wear and tear. Under no circumstances will Seller be liable for incidental or consequential damages resulting from defective products. All other warranties, expressed or implied, whether of merchantability, fitness for purpose, or otherwise are expressly disclaimed by Seller. This warranty does not cover products used for commercial, industrial or educational purposes.

This limited warranty does not apply to accessory items such as blades, drill bits, sanding discs or belts and other related items.

Seller shall in no event be liable for death, injuries to persons or property, or for incidental, contingent, special, or consequential damages arising from the use of our products.

To take advantage of this warranty proof of purchase documentation, which includes date of purchase and an explanation of the complaint, must be provided.

The Seller reserves the right to effect at any time, without prior notice, those alterations to parts, fittings, and accessory equipment which they may deem necessary for any reason whatsoever.

To take advantage of this warranty, please fill out the enclosed warranty card and send it to:
RIKON Warranty
16 Progress Rd.
Billerica, MA. 01821

The card must be entirely completed in order for it to be valid. If you have any questions please contact us at 877-884-5167 or warranty@rikontools.com.

Notes:



For more information:
16 Progress Rd.
Billerica, MA. 01821

877-884-5167 / 978-528-5380
techsupport@rikontools.com
www.rikontools.com

